

**West Marine®**

**FLAT TANK**  
***Oil Changer***



---

***Owner's Manual***

---

**12V, 3.5 GAL (13.2 L) LOW PROFILE DESIGN | MODEL 14557417**

*Made in Taiwan / Fabriqué en Taiwan*

## HELPFUL TIPS

### For faster and more complete oil removal:

Always allow your engine to hit up a bit. Warm oil flows faster and removes contaminants better. Flow rate is dependant upon the oil viscosity and temperature.

**Always have switch in 'OFF' position** before attaching or detaching power cord clips. Always connect red (+) clip to battery (+) positive terminal and black (-) clip to (-) negative terminal.

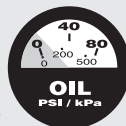

## SAFETY



### CAUTION

This symbol is intended to alert the user to the presence of important instructions. Failure to heed the instructions can result in injury or product damage.



### CAUTION

To prevent injury and damage to the product, please read and follow the instructions in this manual.



### CAUTION

Always vent bilge area.



### CAUTION

Always make sure that bucket lid is secured fastened to bucket prior to transferring oil. See following instructions for securing lid to bucket.



## ! DANGER

### Explosion Hazard

*Never connect or disconnect power cords to power source in an area containing flammable vapors or liquids.*

### Danger d'explosion

*Ne jamais brancher ou débrancher les cordons d'alimentation à une source d'alimentation dans une zone contenant des vapeurs ou liquides inflammables.*



## ! WARNING

### Risk Hazard

*Heated oil can cause serious burns and injuries. Wear appropriate protective safety gear while handling your oil changer.*

## ! ATTENTION

### Risque de brûlures

*L'huile chaude peut causer de graves brûlures et blessures. Portez l'équipement de protection adéquat lors de la manipulation de votre vidangeur d'huile.*



## ! DANGER

### Explosion Hazard

*Never use with gasoline, petrol, or fluids with a flash point below 100°F (38°C).*

### Danger d'explosion

*Ne jamais utiliser avec de l'essence, du pétrole et des fluides dont le point d'éclair est inférieur à 38 °C (100 °F).*

# Operating Instructions

For maximum efficiency, allow your engine to heat up for a few minutes before beginning the oil removal process. Be sure to turn off engine OFF before removing dipstick and inserting suction tube.

## Step 1

Remove dipstick and insert 1/4 in. suction tube into dipstick tube until it reaches pan bottom. Retract tube up to 1/4 in. and secure with tape during the oil removal procedure. *To avoid tube getting caught on internal parts do not force tube beyond pan.*

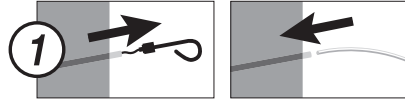

Remove dipstick and insert suction tube

## Step 2

Make sure the pump switch is in the OFF position. Connect the red (+) clip to battery (+) terminal and the black (-) clip to the (-) battery terminal.



Attach power cord clips to engine battery

## Step 3

Activate pump by pressing switch to ON position. Switch pump off when oil removal is complete. The clear suction tube makes it easy to see when oil has been completely removed.

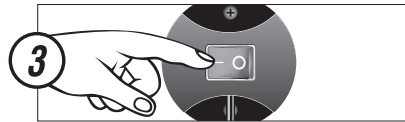

Switch pump on to drain crankcase

## CLEAN-UP AND DISPOSAL

**CONVENIENT** pour spout with threaded cap makes oil disposal easy. For a tidier clean-up, wrap a rag around tube when removing from dipstick tube.

**ALWAYS RECYCLE** or dispose of used oil in an environmentally responsible manner and in compliance with federal and local legislation.

<b>Flat Tank</b>	High-density polyethylene
<b>Pump Body</b>	Electrodeposition coated (EDC) steel
<b>Mounting Base</b>	Electrodeposition coated (EDC) aluminum
<b>Diaphragm</b>	Highly oil-resistant thermoplastic rubber
<b>Valves</b>	Highly oil-resistant fluoroelastomer
<b>Motor</b>	12V DC w/ integral power switch
<b>Receiver</b>	Plastic w/ 3.5 Gal (13.2L) tank
<b>Battery Leads</b>	7 ft (2.1m) w/ battery clips
<b>Suction Tube</b>	8 ft (2.4m), 1/4 in (1.64cm) OD, Nylon

# West Marine 1 Year Limited Warranty

## What Does This Limited Warranty Cover?

West Marine warrants to the original retail purchaser of the West Marine product, where the purchase is made in the United States, that the product will be free from defects in materials and craftsmanship with only the limitations or exclusions set out below.

## How Long Does This Limited Warranty Last?

This limited warranty is valid for twelve (12) months from the date of the original retail purchase from West Marine within the United States (the "Limited Warranty Term").

The warranty period is not extended if we repair or replace a warranted product or any parts. West Marine reserves the right to change the availability of limited warranties, at its discretion, but any changes will not be retroactive and will only apply to subsequent purchases.

## What Does This Limited Warranty Not Cover? This limited warranty does not cover:

- Commercial or industrial use or operation.
- Normal maintenance items or normal wear and tear.
- Problems resulting from fire or submergence in water or other liquids.
- If the product was damaged, modified or altered by you.
- If the product was used as part of any conversion kits, subassemblies, or any configurations not appropriate or contemplated for this product or its use.
- If damage or loss occurring during return shipment of the product to West Marine or its authorized service representative.
- If the product was subject to improper service, repair, installation, storage, maintenance, alteration or application.
- Problems that result from accident, neglect, abuse, misuse or issues with electrical power.
- Problems caused by accessories, parts or components added to the product that are not appropriate for this product or its use.

THIS LIMITED WARRANTY GIVES YOU SPECIFIC LEGAL RIGHTS, AND YOU MAY ALSO HAVE OTHER RIGHTS WHICH VARY FROM STATE TO STATE (OR JURISDICTION TO JURISDICTION). WEST MARINE'S RESPONSIBILITY FOR MALFUNCTIONS AND DEFECTS IN HARDWARE IS LIMITED TO REPAIR OR REPLACEMENT AS SET FORTH IN THIS WARRANTY STATEMENT. ALL EXPRESS AND IMPLIED WARRANTIES FOR THE PRODUCT INCLUDING, BUT NOT LIMITED TO, ANY IMPLIED WARRANTIES AND CONDITIONS OF MERCHANTABILITY AND FITNESS FOR A PARTICULAR PURPOSE, ARE LIMITED IN TIME TO THE LIMITED WARRANTY TERM (AS SPECIFIED ABOVE). NO WARRANTIES, WHETHER EXPRESS OR IMPLIED, WILL APPLY AFTER THE LIMITED WARRANTY TERM HAS EXPIRED. SOME STATES DO NOT ALLOW LIMITATIONS ON HOW LONG AN IMPLIED WARRANTY LASTS, SO THE ABOVE LIMITATIONS MAY NOT APPLY TO YOU.

WE DO NOT ACCEPT LIABILITY BEYOND THE REMEDIES PROVIDED FOR IN THIS LIMITED WARRANTY OR FOR CONSEQUENTIAL OR INCIDENTAL DAMAGES INCLUDING, WITHOUT LIMITATION, ANY LIABILITY FOR THIRD-PARTY CLAIMS AGAINST YOU FOR DAMAGES, FOR PRODUCTS NOT BEING AVAILABLE FOR USE, FOR PERSONAL INJURY AND/OR FOR LOST PROPERTY, DATA OR SOFTWARE. OUR LIABILITY AND THE MAXIMUM AMOUNT FOR WHICH WE ARE RESPONSIBLE WILL BE NO MORE THAN THE AMOUNT YOU PAID FOR THE PRODUCT THAT IS THE SUBJECT OF A CLAIM. SOME STATES DO NOT ALLOW THE EXCLUSION OR LIMITATION OF INCIDENTAL OR CONSEQUENTIAL DAMAGES, SO THE ABOVE LIMITATION OR EXCLUSION MAY NOT APPLY TO YOU.

## What Must I Do To Keep the Warranty in Effect?

- You must keep your receipt or other appropriate documentation as proof of the date of sale and purchase.
- You must use, install, maintain and operate the product in accordance with published specifications and the user's manual.

## What Do I Do If I Need Warranty Service?

- Before the warranty expires, please call us at 1-800-BOATING. Please also have the model number of your West Marine product available.
- When you contact us, we will issue a Return Material Authorization Number for you to include with your return. We will also provide you the address of where to ship the product.
- You must return the product to us in its original or equivalent packaging, prepay shipping charges, and insure the shipment or accept the risk if the product is lost or damaged in shipment.

## What Will West Marine Do?

If the product you return to us proves to be defective in materials or workmanship and not for the reasons which would otherwise disqualify it (as explained above), and is covered under this warranty, we will refund you your money or replace your product by shipping to you to the address you provide us in the United States (excluding Puerto Rico and U.S. possessions and territories).

**Maintenance is the Owner's Responsibility** Cleaning, polishing, lubricating, replacing filters, tuning, replacing worn parts, using your purchased product according to the user's manual, and regularly maintaining your purchased product is your responsibility.

**What if I purchased a Plus Protection Plan?** Service will be provided to you under the terms of the Plus Protection Plan contract. Please refer to that contract for details on how to obtain service.

**How State Law Relates to the Warranty** This warranty gives you specific legal rights, and you may also have other rights which vary from state to state.