



KOKOPELLI

PRODUCT MANUAL



OUR STORY

AT KOKOPELLI we are experts in adventure paddling. Founded on the principle of innovation, our high quality packrafts, kayaks, and SUPs are light enough to go anywhere yet strong enough for anything.

WE BELIEVE the journey is the source of true happiness, not the destination. Across the globe, adventurers have used KokoPELLI packrafts and kayaks to delve deeper, explore longer, and experience untouched destinations like never before. What was once the destination is now just the beginning. In the past, pioneering routes ended at the bottom of the canyon, now it marks the beginning of a remote paddle. Climbing routes once too difficult to access are now opened up by floating gear in. And iconic bikepacking routes are now extended beyond the water.

TABLE OF CONTENTS

WHAT'S IN THE BOX	4
INFLATING YOUR KAYAK	6
DEFLATING YOUR KAYAK	8
SEAT INSTALLATION	9
FIELD REPAIR	10
TIPS & TRICKS	12
SAFETY PRECAUTIONS	13
REGISTER YOUR KAYAK	14
WARRANTY & GUARANTEE	15
PROTECT YOUR WATERS	18

WHAT'S IN THE BOX



PLATTE
KAYAK



EVA SEAT



ANIMAS
RIVER BAG



NANO BARREL PUMP



ALPINE LAKE PADDLE
(4-PIECE)

+ 10IN (25CM)
FOOT BRACE

+ REPAIR KIT



TRACKING
FIN (2X)



PLATTE-PLUS
KAYAK



EVA SEAT (2X)



WHEELED TROLLEY
CARRY BAG



NANO BARREL PUMP



ALPINE LAKE PADDLE
(4-PIECE) (2X)

+ 10IN (25CM)
FOOT BRACE (2X)

+ REPAIR KIT



TRACKING
FIN (2X)

INFLATING YOUR KAYAK

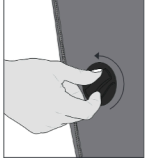

- 1 Open the valve cap by twisting the cap counter-clockwise (to the left). Leave valve stem in the up (closed) position while inflating. If the valve is in the open position, push the valve stem down and twist to the right to close the valve.

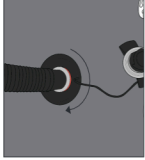

- 2 Insert the pump nozzle into the valve and twist clockwise (to the right) to secure.

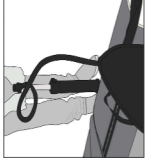

- 3 Raise and lower the pump handle to fill the kayak with air. Inflate drop-stitch floor to 5 PSI. Inflate the pontoons to 2 PSI. Do not overfill.

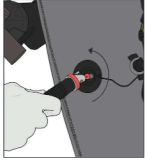

- 4 Unscrew the pump by twisting the nozzle counter-clockwise (to the left). If air escapes, the valve stem is in the open position. Push the valve stem down and turn 1/4 turn to the right and re-inflate. After filling, attach valve cap and twist clockwise (to the right) to secure.*

NOTE: Insert the drop-stitch floor into the inflatable kayak floor base prior to inflation. Always inflate the drop-stitch floor first, and the tubes second.

*The valve cap prevents dirt & debris from entering the valve.

SEAT INSTALLATION



- 1 Insert the kayak seat onto the top of the drop-stitch floor. Place seat in desired position using velcro to hold the seat in place. The seat must be positioned between the back set and the front set of stainless-steel D-rings.



- 2 Attach the rear two straps from the seat to the two rear stainless steel D-rings. Next, attach the two side straps to the front stainless steel D-ring (near the handle).*

DEFLATING YOUR KAYAK

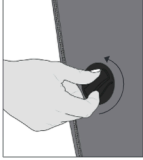

- 1 Open the valve cap by twisting the cap counter-clockwise (to the left). Press the valve stem down and turn 1/4 turn to the left to the OPEN position. Leave it open allowing air to flow out.

*For the Plate-Plus, there are 4 attachment points for one or two seat setup.

FIELD REPAIR



1. Prepare kayak completely. Clean and dry off the affected area. Recommend using rubbing alcohol or alcohol wipe if possible.



2. Peel the patch from the adhesive backing.



3. Apply the sticker by holding the backing in order to avoid touching the patch with your hands.

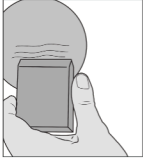

4. Scrape a coin or credit card over the patch until there are no air bubbles. Let dry for 20-30 minutes. The patch will fully cure after 24 hours.

TIPS & TRICKS

- Proper air pressure is 2 PSI for side ports and 3 PSI for side ports. Proper air pressure for drop stitch floor is 5 PSI. Do not over inflate.
- After fully inflating your kayak, cold shock your inflatable kayak by placing it in the water and splashing cold water over the tubes. Add additional air as the air inside the kayak condenses. Add additional air as necessary throughout your paddle (or if the ambient temperature drops) as the air inside the inflatable kayak condenses as it is cooled.
- Always let some air out of your inflatable kayak after removing from water for extended periods of time. The sun's heat will cause the air to expand. The higher air pressure can cause damage to the valve and potentially pop the inflatable kayak.
- Always roll up your inflatable kayak on a tarp or other material to prevent sand or small rocks from being rolled up with the kayak.
- Store in protective dry bag or other type bag if transporting on the outside of your backpack.
- Always travel with a patch kit. Instructions on use can be found on our website at kokoipell.com.
- Store unrolled in a dry location out of the sun. Make sure to properly clean and dry prior to storage.

SCAN TO LEARN MORE



SAFETY PRECAUTIONS

- Never use inflatable kayak in water above their rated level. Do not exceed your paddling ability.
- Always paddle with a partner.
- Always scout unfamiliar water and portage when necessary.
- Always wear proper safety equipment including a PFD, helmet, river shoes, and proper paddling gear.
- Never paddle in flood conditions.
- Never paddle under the influence of drugs or alcohol.
- Be aware of appropriate water levels, tidal changes, dangerous currents, and changing weather.
- Obtain certified first aid training and carry first aid and rescue safety equipment.

REGISTER YOUR INFLATABLE KAYAK

ACTIVATE YOUR WARRANTY AND RECEIVE A FREE BOTTLE OPENER BY REGISTERING
YOUR INFLATABLE KAYAK AT KOKOPELLI.COM/REGISTER.

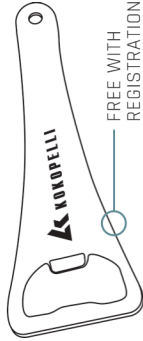

FREE WITH
REGISTRATION

WARRANTY & GUARANTEE

A. GUARANTEE

Kokopelli Outdoor, Inc. offers a 30 day full money back guarantee on all purchases unless otherwise posted as a "no return" or "final" sale. This Return Policy only applies if the product has never been used. Any product returned that is deemed to have been used will result in forfeiture of 30% of the total refund price. If this product is returned to Kokopelli Outdoor, Inc. or the authorized dealer from whom it was purchased, the product must be in original shipping container, with the insurance and shipping charges prepaid by the Buyer. If this product is returned uninsured, the Buyer assumes all risks of loss or damage during shipment.

B. LIMITED WARRANTY

The limited warranty obligations of Kokopelli Outdoor, Inc. for our products are limited to the terms set forth below.

What is Covered. - The limited warranty covers defects in materials and workmanship of all packrafts, kayaks and accessories manufactured and sold by Kokopelli Outdoor, Inc.

What is Not Covered. - This limited warranty does not cover any damage, deterioration or malfunction resulting from any alteration, modification, improper or unreasonable use or maintenance, misuse, abuse, accident, neglect, fire, improper packing, or other acts of nature.

How Long Does this Coverage Last. - The Kokopelli limited warranty as outlined above covers the original owner for a period of lifetime ownership from original

WARRANTY & GUARANTEE

date of purchase*. This warranty is non-transferable and requires proof of purchase from Kokopelli.com.

*Excluded from the Limited Lifetime warranty coverage is the TLZip storage zipper, which is covered by a 1-Year non-transferable warranty period from the original date of purchase (proof of purchase required).

Who is Covered - Only the original purchaser of this product is covered under this limited warranty. This limited warranty is not transferable to subsequent purchasers or owners of this product.

What Kokopelli Outdoor, Inc. Will Do - Kokopelli Outdoor, Inc. will, at its sole discretion, provide one of the following three remedies to whatever extent it shall deem necessary to satisfy a proper claim under this limited warranty:

1. Elect to repair or facilitate the repair of any defective parts within a reasonable period of time, free of any charge for the necessary materials and labor to complete the repair and restore the product to its proper operating condition. Kokopelli Outdoor, Inc. will also pay the shipping costs necessary to return this product once the repair is complete.
2. Replace the product with a direct replacement or with a similar product deemed by Kokopelli Outdoor, Inc. to perform at or above the same function as the original product.
3. Issue a refund of the original purchase price less any discounts given.

What Kokopelli Outdoor, Inc. Will Not Do Under This Limited Warranty - If this product is returned to Kokopelli Outdoor, Inc. or the authorized dealer from which it was purchased, this product must be insured during shipment, with the insurance and shipping charges prepaid by the buyer. If this product is returned uninsured, the Buyer assumes all risks of loss or damage during shipment.

How to Obtain a Remedy Under This Limited Warranty - To obtain a remedy under this limited warranty, you must contact either the authorized Kokopelli Outdoor, Inc., reseller from whom you purchased this product or by emailing Kokopelli Outdoor Inc. directly. For a list of authorized Kokopelli Outdoor, Inc. resellers, visit our Dealer Locator Page here.

In order to pursue any remedy under this limited warranty, you must possess an original, dated receipt as proof of purchase from an authorized Kokopelli Outdoor, Inc. reseller or proof of purchase from Kokopelli Outdoor, Inc.'s online store.

LIMITATION ON LIABILITY

The maximum liability of Kokopelli Outdoor, Inc. under this limited warranty shall not exceed the actual purchase price paid for the product less any discounts. To the maximum extent permitted by law, Kokopelli Outdoor, Inc. is not responsible for direct, special, incidental or consequential damages resulting from any breach of warranty or condition, or under any other legal theory.

To submit a warranty for any Kokopelli Packraft, Kayak or Accessory/Part visit kokopelli.com/pages/warranty

CLEAN. DRAIN. DRY.

CLEAN your boat and gear using the water you just floated in. Remove any mud, sand or vegetation when you leave the water.

DRAIN standing water out of your boat and gear. Squeeze up any hidden water from the nooks and crannies with a towel or a sponge.

DRY your boat by letting the sun do its work. Your chances of spreading invasive species are much lower if everything is dry to the touch.

ALWAYS stop at watercraft inspection stations - it's the law.

No matter how big or small your watercraft, the inspection is mandatory. If you've cleaned and drained, stopping should be pretty painless.

Make sure you clean your gear before you hit the water!

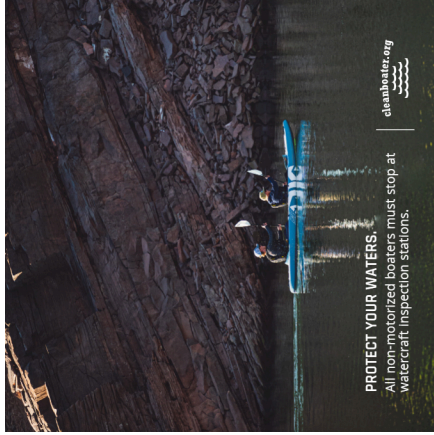

PROTECT YOUR WATERS.
All non-motorized boaters must stop at
watercraft inspection stations.

cleanwater.org





KOKOPELLI

KOKOPELLI.COM

INFO@KOKOPELLI.COM | @KOKOPELLI  