

10MM

SET UP AND ASSEMBLY INSTRUCTIONS:

WAGON SET UP



Open the carton, take out all component parts.

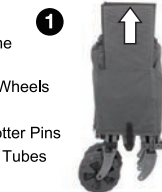

1. Unzip wagon cover and remove wagon bedliner panel.

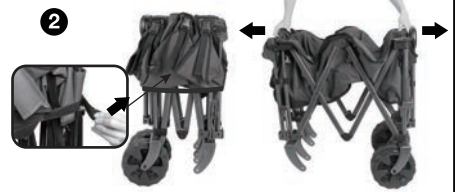

2. Unfasten belt webbing to unfold cart as shown above (do not use excessive force).

ASSEMBLY

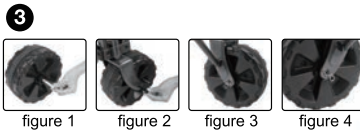

3. To assemble wheels, a) insert aluminum tubes through wheels (fig. 1), b) attach wheels to wagon with bolts (fig. 2), secure with hairpin cotter pins (fig.3 and fig.4).



4. Push button and lift up to extend handle.



5. Place bedliner panels onto wagon bed. Now your wagon is ready to use.

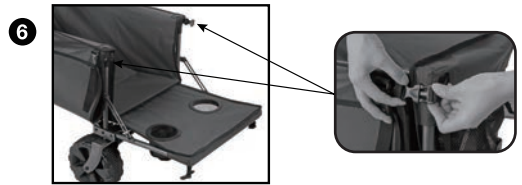

6. Release buckles to open tailgate to accommodate long items (e.g. beach umbrellas, folding chairs, etc.).

CARE AND STORAGE INSTRUCTIONS:



1. Always remove dirt and moisture after each use. If fabric is soiled use a mild cleaning solution.



2. Remove bedliner panels and pull webbing handle up in center of wagon bed to fold up wagon.



3. Face wheels as shown above (fig.5 and fig.6) before closing. Close by fastening belt and zipping cover.



figure 6

WARNING:

1. Never place wagon near fire or high temperature environment which may cause damage to plastic components.
2. Do not use on uneven surfaces as that can shorten product life.
3. This wagon is specifically designed for storage and transport only.
4. This wagon is NOT a toy. DO NOT allow children to ride in wagon.
5. MAXIMUM CAPACITY 180 lbs. – Exceeding maximum capacity limit may cause damage to cart.
6. Use care when assembling/disassembling to avoid injury.
7. To avoid damage to frame and plastic components DO NOT STORE OUTSIDE.

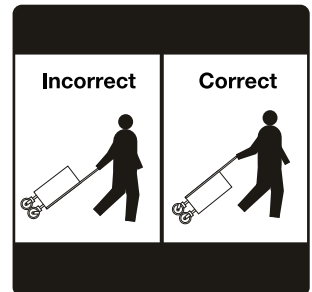

200MM

132MM